

Digital Large Format Colour Printer

RICOH IP CW2200

✓ Printer

RICOH
imagine. change.



IP CW2200

A1 3.8 ppm

Enhance your productivity with Ricoh's new wide format printer

Designed to deliver impressive results at high speed, the RICOH IP CW2200 is the latest addition to Ricoh's wide format printer range and offers consistent quality, durability and performance for busy project teams working with technical drawings, design graphics or other A1/A0 documents. Combined with Ricoh's innovative GEL-Jet™ technology, your printed documents not only retain their colour and clarity, thanks to our UV and water resistant inks, but are waterproof too, so are perfect when working on outdoor projects.

- Easy to use large format printer
- High monochrome print speeds of up to 3.8ppm/A1
- Automatic paper roll setting - no need to hand feed the paper
- Impressive continuous printing – print documents up to 33 metres long
- Useful flat top offering workable surface





Fast, flexible and efficient

Produce CAD drawings, poster designs, construction plans and other large format documents at high speed and with precision accuracy. With automatic paper roll handling and maximum printable lengths of up to 33 metres, the RICOH IP CW2200 meets all your large format printing needs.

Intuitive, productive and reliable

The RICOH IP CW2200 features our newly designed touch screen providing simple and easy to use operating instructions to help reduce downtime. And with the high standards of quality and colour consistency you've come to expect from Ricoh, this is a printer your team can rely on.

Designed to suit you and your business

Built for productivity

With impressive print speeds the RICOH IP CW2200 enables your team to generate high quality, large format prints in record time.



Designed for efficiency

Designed to ensure minimal user training and ease of use, your teams have more time to focus on their jobs and spend less time at the printer.

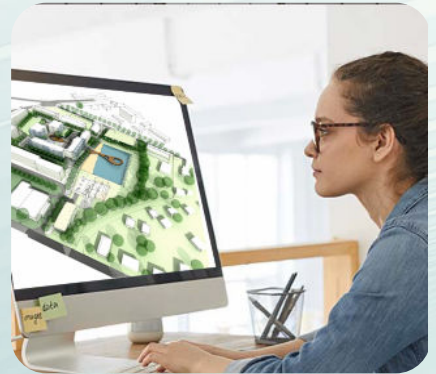

Constructed for convenience

Changing the paper roll is now even easier thanks to the automatic paper roll feeding, which holds 175m rolls of paper. So it saves time, saves paper and offers increased convenience.



Developed for usability

The newly designed colour touch screen and intuitive smart operation panel offers an easy to navigate colour touchscreen interface, which is consistent with other RICOH products, so no user training is required.



Give your business a competitive edge

Innovative print technology

Showcase your designs from precise line drafts to boldly coloured 3D renders with the highest accuracy and finest details. Our waterproof GEL-Jet™ technology uses inks that are smudge free and UV resistant, so your prints are high quality, durable, and can be viewed on site, in any weather.



Next generation controller panel

The new design colour touch screen on the RICOH IP CW2200's Smart Operation Panel offers an intuitive and easy to use customer interface. The versatile functionality and fast, simple navigation help to reduce operation error and improve the way you interact with the device.



Enhanced productivity & easy operation

Production downtime is key for any business, so thanks to the automatic paper roll setting, we've ensured this device requires minimum user attention. In addition, up to 33 metres long can be printed continuously, thereby increasing productivity.



Fast, accurate print speeds

We understand that time is precious when your teams are working on large design, architectural or construction projects, so we've ensured our large format printers deliver high performance quality at impressive speeds of up to 3.8ppm at A1 size.



Industry-leading quality and superb reliable service

Extra peace of mind

Our fast response network of experienced staff are on hand to help you address any concerns or issues that may arise. We want you to feel confident in the speed and capability of our service.



A consultative approach

RICOH is committed to working closely with its customers to help determine which technology solution is best for your business and your investment in new print technology enables profit.



Putting your business safety first

We build a range of security measures into our products which include administrator/user authentication, document scanning encryption and external authentication, to restrict access and protect files.



Minimising environmental impact

We're committed to conserving the planet's resources and work consciously to minimise our environmental impact on resource extraction, energy consumption, chemical discharge and carbon emissions.



The RICOH IP CW2200 new generation large format printer



- 1** A workable flat top that can be used as extra work space for operators.
- 2** Maximum print length of 33 meters long allowing for extended print runs.
- 3** High print speeds of 3.8ppm for A1 mono and 2.1ppm for A1 colour available.
- 4** Smart stacking option with simple and easy to use stacker system.
- 5** Easy to use smart operation panel as standard, that is common with other Ricoh devices.
- 6** Automatic paper roll setting: no need to hand feed the paper.
- 7** Uses environmentally friendly Ricoh GEL-Jet technology in a CMYK configuration.

RICOH IP CW2200

Main specs

GENERAL

Configuration	Console
Copying/printing process	On-demand Piezo inkjet system (pigment-based ink)
Resolution	600 x 600 dpi
Memory capacity	4 GB
Hard Disk Drive	320 GB
Power source	220 - 240 V, 1.9 A (max.), 50/60 Hz
Dimensions (W x D x H)	1,384 x 660 x 1,117 mm
Weight	100 kg

PRINTER

Controller board	Embedded
CPU	1.6 GHz
Print speed	A1 LEF: B/W: 3.8 ppm, Colour: 2.1 ppm A0 SEF: B/W: 1.9 ppm, Colour: 1.1 ppm
Print resolution	Speed priority (drawing): 600 x 300 dpi Speed priority: 600 x 300 dpi Standard: 600 x 600 dpi Quality priority: 600 x 600 dpi Quality priority mode for only coated paper, film (matted) and special paper: 1,200 x 1,200 dpi
Print drivers	Adobe Postscript
Fonts	European 136 fonts (PS3)
Network interface: standard	10/100/1000 base-TX USB 2.0
Network interface: optional	Wireless LAN IEEE 802.11a/b/g/n
Network protocol: standard	TCP/IP (IPv4, IPv6)
Standard MIB	MIB-II (RFC1213) Host Resource (RFC1514) Printer MIB (RFC1759)
Private MIB	Original
Supported OS	Windows 8.1/10 (32/64bit), Windows 11, Server 2012/R2, Server 2016/2019/2022 MacOS 10.14 or later Citrix XenApp 7.15 LTSR, VirtualApps/Desktops 2012 or later OES 1.0, 2.0
Media to print	Yes (JPEG/TIFF/PDF)
Printer features	Sample Print, Locked Print, Hold Print, Stored Print, Store and Print, Unauthorized Copy Prevention, One Direction, WSD Printer, Color Matching, POP, CUD, Media to Print (JPEG/TIFF/PDF), PDF Direct Print, Ink save mode (save ratio: %), Encrypted Secure Print, Auto Job Promotion, Bonjour Support, Media Direct Print, Barrier-free Color Management Mode, Scheduled Print, Banner Page Print, System Reset Timer, Classification Mode, Emergency Print, Standard MIB, Private MIB, Black Over Print, Tray-Parameter Change from WebImageMonitor, Poster Print

PAPER HANDLING

Output paper size	Maximum Roll Feeder: 914.4 mm width, 33,000 mm length Maximum bypass: 914.4 mm width, 2,000 mm length
Output paper weight	Roll Paper: 0.068 - 0.2 mm (51 -190 g/m ²) Cut Sheet: 0.068 - 0.4 mm (51 -220 g/m ²)
Roll paper width	297/364/420/440/490/515/594/610/620/625/660/680/707/728/800/841/880/914.4 mm
Paper feeding capacity	Width: 297 - 914 mm, 11" - 36" Bypass: 1 sheet
Paper output capacity	1 sheet(s) (plain paper)

ECOLOGY

Maximum power consumption	160 W
---------------------------	-------

For availability of models, options and software, please consult your local supplier.

RICOH
imagine. change.

Ricoh Nederland B.V.
Magistratenlaan 2
5233 MD 's-Hertogenbosch
Nederland
Tel.: +31 (0)73 6453636
Fax.: +31 (0)73 6451844
www.ricoh.nl

ISO9001 certified, ISO14001 certified, ISO27001 certified

Copyright © 2023 Ricoh Europe PLC. All rights reserved. This brochure, its contents and/or layout may not be modified and/or adapted, copied in part or in whole and/or incorporated into other works without the prior written permission of Ricoh Europe PLC.